

**LOS ANGELES COUNTY
DEPARTMENT OF PUBLIC WORKS**

OFFICE COPY

BENCH MARK LIST



OFFICE COPY

WATTS QUAD

1990 ADJUSTMENT

PREFACE 1990

The Department of Public Works level net is composed of more than 1,700 miles of levels supporting in excess of 9,000 bench marks. In 1990, a major readjustment of the Baseline and nets was undertaken. To emphasize the complete break with previous elevations, the CY, CG & CL series bench marks have been relabeled DY, DG, & DL, respectively.

To facilitate the adjustment, indexing, and distribution of adjusted values of the net, the County territory is divided into 33 quads or areas. For identification purposes each quad is given a name, viz., "Rosemead," "La Mirada," "Santa Fe", etc. When bench marks and elevations in these nets are used, the name of the quad and the date of the adjustment must be included in the bench mark description, e.g.,

DY 9701 - RDBM TAG IN CB 5FT S/O BCR @ SE COR BOLSA ST & DOMINGUEZ ST
63FT S & 20FT E/O C/L INT
(GARDENA - 1990)

ELEV. 16.704

Experience indicates that this general adjustment will, for the most part, remain sound for the next 10 years. Updating constrained adjustments will be made in 5 years. It is expected that these updating adjustments will be in the nature of a few hundredths of a foot. When a quad is readjusted, new elevation lists will be published and the date of the readjustment will be noted in the bench mark description. Two bench marks with different adjustment dates will not normally agree with each other.

The basic accuracy of the net is reflected by an indicated field probable error of plus or minus 0.012 foot per mile of leveling as determined from over 600 conditions of closure. However, many years experience in vertical control in the greater Los Angeles basin and Antelope Valley indicate that because of varying degrees of subsidence and heaving, the true datum is recovered only by obtaining substantial agreement of a number of bench marks.

The users of this net are invited to assist in its maintenance by notifying this Department of cases of obliteration, apparent mistakes in descriptions or elevations, and proven disturbance of bench marks.

DATUM: U.S. Coast and Geodetic Survey Sea Level Datum
of 1929, through the medium of the Los Angeles
County Engineer Precise Level Net.

ABBREVIATIONS USED IN BENCH MARK LISTINGS

ABUT -----	Abutment	ECR -----	End of Curb Return
ALG -----	Along	EC -----	End of Curve
ANG PT -----	Angle Point	ENT -----	Entrance
B/W -----	Back of Walk	FL -----	Floor
BCR -----	Beginning of Curb Return	FTG -----	Footing
BC -----	Beginning of Curve	FRWY -----	Freeway
BLDG -----	Building	F/W -----	Front of Walk
BM -----	Bench Mark	GAR -----	Garage
BT SPK -----	Boat or Bolt Spike	HDWL -----	Headwall
BR CAP -----	Brass or Bronze Cap	HSE -----	House
C B -----	Catch Basin	HWY -----	Highway
CTR -----	Center	INT -----	Intersection
C/L -----	Center Line	IP -----	Iron Pipe
C/L INT -----	Center Line Intersection	LT -----	Left
C/L PROD -----	Center Line Produced	LACE -----	L.A. City Engineer
CONC -----	Concrete	LACS -----	L.A. Co. Engineer
COR -----	Corner	LAFC -----	L.A. Co. Flood Control
COE -----	Corps of Engineers	L&BN -----	Lead and Bench Nail
CULV -----	Culvert	L&BR -----	Lead and Brad
CYN -----	Canyon	L&N -----	Lead and Nail
CB -----	Curb	L&SPK -----	Lead and Spike
CS MON -----	Co. Eng. Monument	L&T -----	Lead and Tack
CT SPK -----	Cut Spike	MCR -----	Middle of Curb Return
DPW -----	Dept. of Public Works	MKD -----	Marked
DR -----	Drive or Driveway	MC -----	Middle of Curve
E/O -----	East of	MON -----	Monument

ABBREVIATIONS USED IN BENCH MARKS (CON'T)

N/O ----- North of
NR ----- Near
OPP ----- Opposite
PI ----- Point of Intersection
PK&W ----- PK Nail and Washer
P/L ----- Property Line
POST ----- Point of Semi-Tangent
PP ----- Power Pole
PVMT ----- Pavement
PROD ----- Produced
RD ----- Road
RDBM ----- Road Dept. Bench Mark
RDBM TAG ----- Road Dept. Bench Mark Tag
RR ----- Railroad
RT ----- Right
R/W ----- Right of Way
SDMH ----- Storm Drain Manhole
SMH ----- Sewer Manhole
SPK ----- Spike
ST&W ----- Spike Tin and Washer
S/O ----- South of
TP ----- Telephone Pole
USC&GS ----- U.S. Coast and Geodetic Survey
USGS ----- U.S. Geological Survey
WK ----- Walk
W/O ----- West of

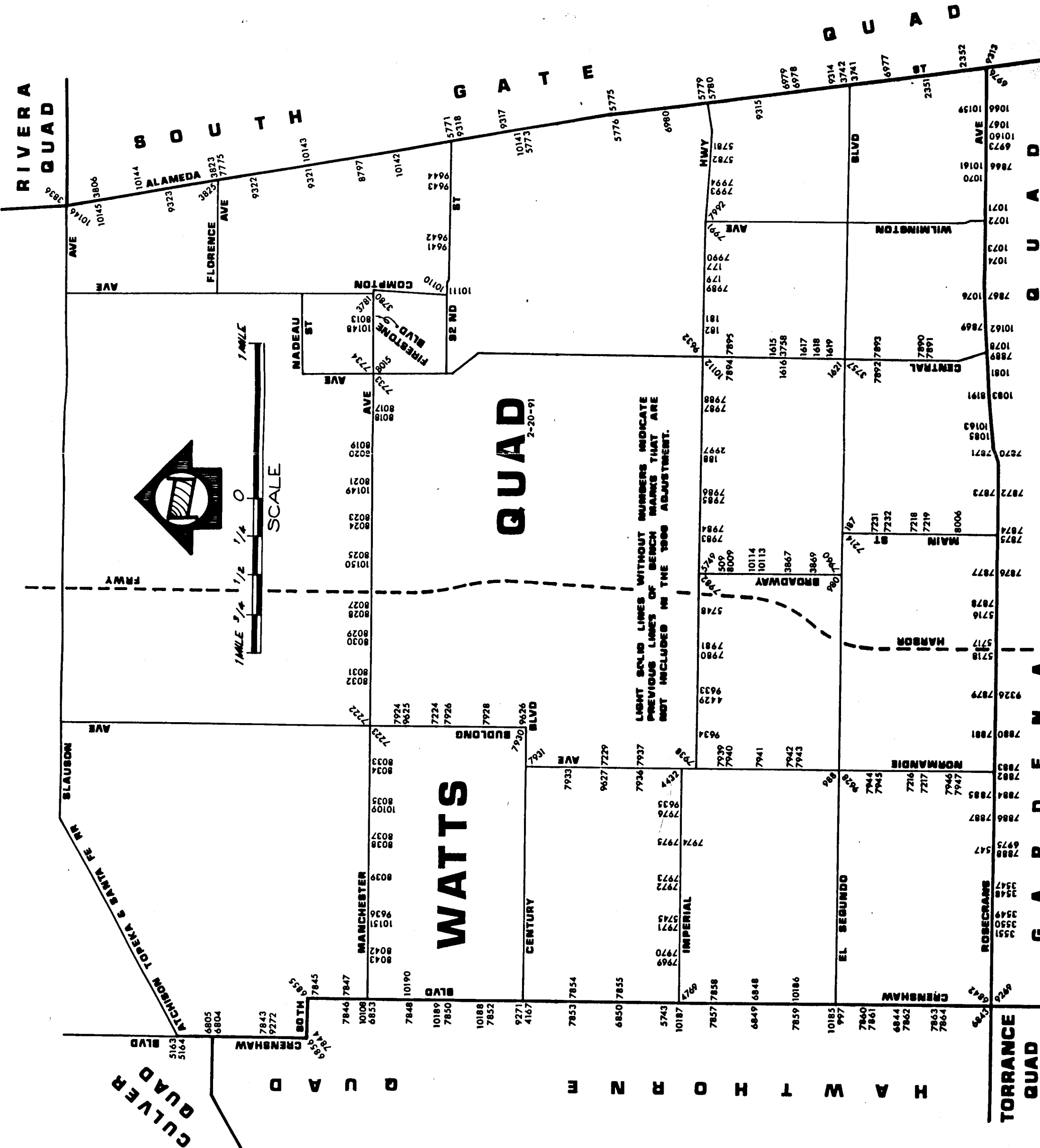

CULVER QUAD

QUAD

HAWTHORN QUAD

TORRANCE QUAD

GARRDEN QUAD

QUAD

RIVERA QUAD

SOUTH

GATT

QUAD
2-20-91

WATTS

AVE
10146
10145
10144
3823
3822
7775
9322
9321
10143
8797
10142
9644
9643
5771
9318
10141
5773
9317
5776
5775
6980
5779
5780

AVE
1010
1011
1010
1011

AVE
1010
1011

AVE
1010
1011

AVE
1010
1011

AVE
1010
1011

AVE
1010
1011

AVE
1010
1011

AVE
1010
1011

AVE
1010
1011

AVE
1010
1011

AVE
1010
1011

AVE
1010
1011

AVE
1010
1011

AVE
1010
1011

AVE
1010
1011

AVE
1010
1011

AVE
1010
1011

AVE
1010
1011

AVE
1010
1011

AVE
1010
1011

AVE
1010
1011

AVE
1010
1011

AVE
1010
1011

AVE
1010
1011

AVE
1010
1011

AVE
1010
1011

AVE
1010
1011

AVE
1010
1011

AVE
1010
1011

AVE
1010
1011

AVE
1010
1011

AVE
1010
1011

AVE
1010
1011

AVE
1010
1011

AVE
1010
1011

AVE
1010
1011

AVE
1010
1011

AVE
1010
1011

AVE
1010
1011

AVE
1010
1011

AVE
1010
1011

AVE
1010
1011

AVE
1010
1011

AVE
1010
1011

AVE
1010
1011

AVE
1010
1011

AVE
1010
1011

AVE
1010
1011

AVE
1010
1011

AVE
1010
1011

AVE
1010
1011

AVE
1010
1011

AVE
1010
1011

AVE
1010
1011

AVE
1010
1011

AVE
1010
1011

AVE
1010
1011

AVE
1010
1011

AVE
1010
1011

AVE
1010
1011

AVE
1010
1011

AVE
1010
1011

AVE
1010
1011

AVE
1010
1011

AVE
1010
1011

AVE
1010
1011

AVE
1010
1011

AVE
1010
1011

AVE
1010
1011

AVE
1010
1011

AVE
1010
1011

AVE
1010
1011

AVE
1010
1011

AVE
1010
1011

AVE
1010
1011

AVE
1010
1011

AVE
1010
1011

AVE
1010
1011

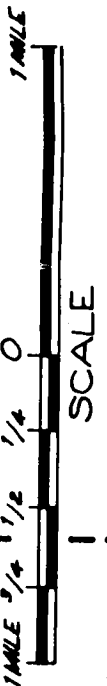

SCALE

FRWY

LIGHT SOLID LINES WITHOUT NUMBERS INDICATE PREVIOUS LINES OF BENCH MARKS THAT ARE NOT INCLUDED IN THE 1980 ADJUSTMENT.

BLAUSON AVE

ATCHISON TOWER & SANTA FE HWY

5163
5164
6805
6804
7843
9272
80TH CRENshaw

7844
7847
10108
6853
7848
10190
10189
7850
10188
7852
9271
4167

MANCHESTER

8043
8042
10151
9636
8039
8038
8037
10109
8035
8034

7223

8032
8031
8030
8029
8028
8027
10150
8025
8024
8023
10149
8021
8020

MADEAU ST
7733
7734
7735
7736
7737
7738
7739
7740
7741
7742
7743
7744
7745
7746
7747
7748
7749
7750
7751
7752
7753
7754
7755
7756
7757
7758
7759
7760
7761
7762
7763
7764
7765
7766
7767
7768
7769
7770
7771
7772
7773
7774
7775
7776
7777
7778
7779
7780
7781
7782
7783
7784
7785
7786
7787
7788
7789
7790
7791
7792
7793
7794
7795
7796
7797
7798
7799
7800

COMPTON

9642
9641
9640
9639
9638
9637
9636
9635
9634
9633
9632
9631
9630
9629
9628
9627
9626
9625
9624
9623
9622
9621
9620
9619
9618
9617
9616
9615
9614
9613
9612
9611
9610
9609
9608
9607
9606
9605
9604
9603
9602
9601
9600

BUDLONG

7924
9625
7224
7926
7928
9626
9626

7933
9627
7229
7936
7937

9634
7939
7940
7941
7942
7943

9634
7939
7940
7941
7942
7943

CENTURY

7970
7971
7972
7973
7974
7975
7976
9635
7976
7977
7978
7979
7980
7981
7982
7983
7984
7985
7986
7987
7988
7989
7990
7991
7992
7993
7994
7995
7996
7997
7998
7999
8000

10114
10113
3867
3869
3870
3871
3872
3873
3874
3875
3876
3877
3878
3879
3880
3881
3882
3883
3884
3885
3886
3887
3888
3889
3890
3891
3892
3893
3894
3895
3896
3897
3898
3899
3900

1615
1616
1617
1618
1619
1620
1621
1622
1623
1624
1625
1626
1627
1628
1629
1630
1631
1632
1633
1634
1635
1636
1637
1638
1639
1640
1641
1642
1643
1644
1645
1646
1647
1648
1649
1650

10141
5773
9317
5776
5775
6980
5779
5780

8006
7218
7219
7220
7221
7222
7223
7224
7225
7226
7227
7228
7229
7230
7231
7232
7233
7234
7235
7236
7237
7238
7239
7240
7241
7242
7243
7244
7245
7246
7247
7248
7249
7250

7874
7875
7876
7877
7878
7879
7880
7881
7882
7883
7884
7885
7886
7887
7888
7889
7890
7891
7892
7893
7894
7895
7896
7897
7898
7899
7900

7890
7891
7892
7893
7894
7895
7896
7897
7898
7899
7900

7900
7901
7902
7903
7904
7905
7906
7907
7908
7909
7910
7911
7912
7913
7914
7915
7916
7917
7918
7919
7920

7920
7921
7922
7923
7924
7925
7926
7927
7928
7929
7930
7931
7932
7933
7934
7935
7936
7937
7938
7939
7940

7940
7941
7942
7943
7944
7945
7946
7947
7948
7949
7950
7951
7952
7953
7954
7955
7956
7957
7958
7959
7960

7960
7961
7962
7963
7964
7965
7966
7967
7968
7969
7970
7971
7972
7973
7974
7975
7976
7977
7978
7979
7980

7980
7981
7982
7983
7984
7985
7986
7987
7988
7989
7990
7991
7992
7993
7994
7995
7996
7997
7998
7999
8000

8000
8001
8002
8003
8004
8005
8006
8007
8008
8009
8010
8011
8012
8013
8014
8015
8016
8017
8018
8019
8020

8020
8021
8022
8023
8024
8025
8026
8027
8028
8029
8030
8031
8032
8033
8034
8035
8036
8037
8038
8039
8040

8040
8041
8042
8043
8044
8045
8046
8047
8048
8049
8050
8051
8052
8053
8054
8055
8056
8057
8058
8059
8060

8060
8061
8062
8063
8064
8065
8066
8067
8068
8069
8070
8071
8072
8073
8074
8075
8076
8077
8078
8079
8080

8080
8081
8082
8083
8084
8085
8086
8087
8088
8089
8090
8091
8092
8093
8094
8095
8096
8097
8098
8099
8100

8100
8101
8102
8103
8104
8105
8106
8107
8108
8109
8110
8111
8112
8113
8114
8115
8116
8117
8118
8119
8120

8120
8121
8122
8123
8124
8125
8126
8127
8128
8129
8130
8131
8132
8133
8134
8135
8136
8137
8138
8139
8140

8140
8141
8142
8143
8144
8145
8146
8147
8148
8149
8150
8151
8152
8153
8154
8155
8156
8157
8158
8159
8160

8160
8161
8162
8163
8164
8165
8166
8167
8168
8169
8170
8171
8172
8173
8174
8175
8176
8177
8178
8179
8180

8180
8181
8182
8183
8184
8185
8186
8187
8188
8189
8190
8191
8192
8193
8194
8195
8196
8197
8198
8199
8200

8200
8201
8202
8203
8204
8205
8206
8207
8208
8209
8210
8211
8212
8213
8214
8215
8216
8217
8218
8219
8220

8220
8221
8222
8223
8224
8225
8226
8227
8228
8229
8230
8231
8232
8233
8234
8235
8236
8237
8238
8239
8240

8240
8241
8242
8243
8244
8245
8246
8247
8248
8249
8250
8251
8252
8253
8254
8255
8256
8257
8258
8259
8260

8260
8261
8262
8263
8264
8265
8266
8267
8268
8269
8270
8271
8272
8273
8274
8275
8276
8277
8278
8279
8280

8280
8281
8282
8283
8284
8285
8286
8287
8288
8289
8290
8291
8292
8293
8294
8295
8296
8297
8298
8299
8300

8300
8301
8302
8303
8304
8305
8306
8307
8308
8309
8310
8311
8312
8313
8314
8315
8316
8317
8318
8319
8320

8320
8321
8322
8323
8324
8325
8326
8327
8328
8329
8330
8331
8332
8333
8334
8335
8336
8337
8338
8339
8340

8340
8341
8342
8343
8344
8345
8346
8347
8348
8349
8350
8351
8352
8353
8354
8355
8356
8357
8358
8359
8360

8360
8361
8362
8363
8364
8365
8366
8367
8368
8369
8370
8371
8372
8373
8374
8375
8376
8377
8378
8379
8380

8380
8381
8382
8383
8384
8385
8386
8387
8388
8389
8390
8391
8392
8393
8394
8395
8396
8397
8398
8399
8400

8400
8401
8402
8403
8404
8405
8406
8407
8408
8409
8410
8411
8412
8413
8414
8415
8416
8417
8418
8419
8420

8420
8421
8422
8423
8424
8425
8426
8427
8428
8429
8430
8431
8432
8433
8434
8435
8436
8437
8438
8439
8440

8440

QUAD-YEAR	ELEV	DESCRIPTION (INCLUDE QUAD AND YEAR IN DESCRIPTION)	BM NUMBER
WATTS (1990)	93.343	FLT HD SPK S CB 40FT S C/L IMPERIAL HWY @ C/L PROD GRANDEE AVE	DY 177
WATTS (1990)	92.876	LA CITY ENG HEX MON IN WELL 14IN DN ON C/L IMPERIAL HWY 25FT W C/L COMPTON AVE TO N	DY 179
WATTS (1990)	93.417	L&BN S CB 3FT W BCR 40FT S C/L IMPERIAL HWY & 40FT W C/L SUCCESS AVE	DY 181
WATTS (1990)	93.922	L&BN S CB 3FT W BCR 40FT S C/L IMPERIAL HWY & 35FT W C/L PARMELEE AVE	DY 182
WATTS (1990)	134.583	RDBM TAG N CB 1FT W BCR @ NW COR EL SEGUNDO BLVD & MAIN ST 66FT W & 40FT N C/L INT	DY 187
WATTS (1990)	110.594	RDBM TAG W CB 1FT S BCR 61FT S & 30FT W C/L INT IMPERIAL HWY & AVALON BLVD	DY 188
WATTS (1990)	152.270	L & T IN W CB 42FT N & 21FT W C/L INT BROADWAY & 117TH ST ON C/L PROD 116TH PL	DY 509
BASELINE (1990)	47.279	L&T IN CB @ NE COR WESTERN AVE & ROSECRANS AVE 40FT E & 64FT N (1FT S/O BCR)	DY 547
WATTS (1990)	147.161	RDBM TAG N CB 1FT W BCR @ EL SEGUNDO BLVD & BROADWAY 40FT N & 74FT W C/L INT	DY 980
WATTS (1990)	122.634	RDBM TAG N CB 1FT W BCR @ NW COR NORMANDIE AVE & EL SEGUNDO BLVD 38FT N & 56FT W C/L INT	DY 988
BASELINE (1990)	51.156	LAFC MON 12IN DN 50FT S C/L EL SEGUNDO BLVD & 175FT E C/L CRENSHAW BLVD ON W P/L DOMINGUEZ LAFC CHANNEL MKD (1959-27 75A CO ENGR)	DY 997
BASELINE (1990)	69.748	L&T NR CTR CB RET @ NW COR WILLOWBROOK AVE W BARREL & ROSECRANS AVE 43FT N & 45FT W C/L INT	DY 1066
BASELINE (1990)	69.525	L&T NR CTR CB RET @ NE COR ACACIA ST & ROSECRANS AVE 42FT N & 45FT E C/L INT	DY 1067
BASELINE (1990)	72.950	L & BR 7FT W BCR 42FT N & 25FT E C/L INT ROSECRANS AVE & MATTHISEN AVE CTR CB RET	DY 1070
BASELINE (1990)	75.125	L&T CTR CB RET NE COR WILMINGTON AVE & ROSECRANS AVE 46FT N & 40FT E C/L INT	DY 1071
BASELINE (1990)	75.037	L&T CTR CB RET NW COR WILMINGTON AVE & ROSECRANS AVE 45FT N & 40FT W C/L INT	DY 1072

QUAD-YEAR	ELEV	DESCRIPTION (INCLUDE QUAD AND YEAR IN DESCRIPTION)	BM NUMBER
BASELINE (1990)	75.905	CS MON IN WELL 38FT N C/L ROSECRANS AVE & 38FT W OF NW COR CONC BRIDGE OVER COMPTON CREEK 164FT E C/L DWIGHT ST MKD (CS MON BM 21-2-1952 RE 63)	DY 1073
BASELINE (1990)	77.370	L&BN N CB 2FT E BCR @ NE COR ROSECRANS AVE & DWIGHT ST 38FT N & 35FT E C/L INT	DY 1074
BASELINE (1990)	85.088	L&BN IN E CB 65FT S & 23FT E C/L INT ROSECRANS AVE & TAJAUTA AVE (0.4FT S/O BCR)	DY 1076
BASELINE (1990)	100.372	CS MON IN WELL 44FT N C/L ROSECRANS AVE 105FT E C/L CENTRAL AVE 32FT E BCR 4FT N CB MKD (BM 21-3 1952 RE 63)	DY 1078
BASELINE (1990)	105.441	L&BN 4IN S BCR @ SE COR KEENE AVE & ROSECRANS AVE 106FT S & 24FT E C/L INT	DY 1081
BASELINE (1990)	109.903	L&T S CB ROSECRANS AVE SERVICE RD 1FT E/O BCR 55FT E C/L CAHITA AVE & 76FT S C/L ROSECRANS AVE MKD (BM)	DY 1083
BASELINE (1990)	114.081	L&BN N CB ROSECRANS AVE 1FT W BCR @ NW COR ROSECRANS AVE & STANFORD AVE 40FT N & 52FT W C/L INT	DY 1085
WATTS (1990)	91.092	L&SPK 3FT E/O BCR 28FT S & 64FT E/O C/ INT CENTRAL AVE & 120TH ST	DY 1615
WATTS (1990)	90.123	L&BN IN CB ALAMEDA ST 38F W/O C/L CENTRAL AVE & 75FT S C/L 121ST PL	DY 1616
WATTS (1990)	89.780	L&BN 1FT N BCR NE COR 124TH ST SERVICE ROAD & CENTRAL AVE (SER RD) 44FT N & 80FT E C/L INT	DY 1617
WATTS (1990)	89.578	L&BN 1FT N BCR @ NE COR 126TH ST SERVICE ROAD & CENTRAL AVE (SER RD) 41FT N & 80FT E C/L INT	DY 1618
WATTS (1990)	89.373	L&BN 1FT N BCR 43FT N & 83FT E C/L INT CENTRAL AVE (SERVICE RD) & 127TH ST	DY 1619
WATTS (1990)	91.356	R D MON IN WELL @ C/L CENTRAL AVE 30FT N C/L EL SEGUNDO PL	DY 1621
BASELINE (1990)	72.882	L&T E CB ALAMEDA ST 33FT S OF N CB ORIS ST PROD	DY 2351
BASELINE (1990)	70.627	L&T E CB ALAMEDA ST ON C/L PROD MEALY ST	DY 2352
WATTS (1990)	108.970	LACE MON IN WELL @ C/L INT IMPERIAL HWY & AVALON BLVD (N OF TWO MON 4FT APART)	DY 2997

QUAD-YEAR	ELEV	DESCRIPTION (INCLUDE QUAD AND YEAR IN DESCRIPTION)	BM NUMBER
BASELINE (1990)	44.878	L&T S CB 1FT E BCR 40FT E & 40FT S C/L INT ROSECRANS AVE & GRAMERCY PL	DY 3547
BASELINE (1990)	44.573	L&T W CB GRAMERCY PL 1FT S OF BCR 18FT W & 60FT S C/L INT ROSECRANS AVE & GRAMERCY PL	DY 3548
BASELINE (1990)	45.047	RDBM TAG 7FT E BCR 40FT S & 75FT E C/L INT ROSECRANS AVE & VAN NESS AVE (IN S CB)	DY 3549
BASELINE (1990)	46.196	RDBM TAG W CB VAN NESS AVE 5FT N BCR 30FT W & 68FT N C/L INT ROSECRANS AVE & VAN NESS AVE	DY 3550
BASELINE (1990)	44.296	CS MON 90FT S C/L ROSECRANS AVE & 30FT W C/L VAN NESS AVE 1.5FT BACK OF CURB	DY 3551
BASELINE (1990)	79.774	BR CAP @ S END W CONC BANNISTER @ MAIN ENT TO THE (FRANCIS WILLARD SCHOOL) 114FT E C/L ALAMEDA ST E BBL & 98FT S C/L EL SEGUNDO BLVD MKD (W 615 1941)	DY 3741
BASELINE (1990)	75.467	CS MON IN WELL 27FT E C/L ALAMEDA ST W BBL & 3FT S/O C/L EL SEGUNDO BLVD	DY 3742
WATTS (1990)	92.047	BN 2FT S BCR @ SW COR CENTRAL AVE & EL SEGUNDO BLVD 65FT S & 38FT W C/L INT	DY 3757
WATTS (1990)	90.959	L&BN 2FT N BCR 50FT N & 38FT E C/L INT CENTRAL AVE & 121ST ST	DY 3758
WATTS (1990)	128.457	L&T N CB FIRESTONE BLVD 35FT N/O C/L ON C/L PROD COMPTON AVE FROM THE S	DY 3780
WATTS (1990)	129.015	L&T 5FT E/O BCR @ NW COR FIRESTONE BLVD & COMPTON AVE TO N 37FT N & 47FT W/O C/L INT	DY 3781
BASELINE (1990)	178.696	DISC IN S WALL 2FT E OF THE SW COR & 3FT ABOVE RANDOLPH ST & E BBL ALAMEDA ST 8FT N/O N CB & 8FT E/O E CB	DY 3806
BASELINE (1990)	154.063	L&BN 1FT W BCR @ NW COR W BBL ALAMEDA ST & FLORANCE AVE 30FT N & 40FT W/O C/L INT	DY 3823
BASELINE (1990)	157.163	CS MON SW COR MILLER GASKET CO BLDG 2FT ABOVE GROUND & 3 FT W OF THE BLDG COR 86FT E OF E CB ALAMEDA ST & 1FT N OF THE N CB OF FLORENCE AVE	DY 3825
BASELINE (1990)	178.957	CS MON C/L SLAUSON AVE 14FT W OF W RAIL SPRR 20FT E C/L ALAMEDA ST MKD (WATTS H-2A 1939)	DY 3836
WATTS (1990)	173.182	L&T 2FT N/O BCR 69FT N & 38FT E/O C/L INT BROADWAY & 124TH ST	DY 3867

QUAD-YEAR	ELEV	DESCRIPTION (INCLUDE QUAD AND YEAR IN DESCRIPTION)	BM NUMBER
WATTS (1990)	154.556	L&T W CH 2FT N & 38FT W/O C/L INT BROADWAY & 127TH ST	DY 3869
BASELINE (1990)	167.204	LACS BM MON IN WELL 2FT BK OF CB & APPROX CTR OF SW CB RET CRENSHAW BLVD & CENTURY BLVD 50FT S & 47FT W/O C/L INT MKD (BM 27-68 1953 RE 63)	DY 4167
WATTS (1990)	197.051	BM TAG N CB 1FT W/O BCR @ NW COR VERMONT AVE (W BBL)& IMPERIAL HWY 40FT N & 40FT W/O C/L INT	DY 4429
WATTS (1990)	202.425	L&T @ MCR 42FT N & 44FT W/O C/L INT NORMANDIE AVE & IMPERIAL HWY	DY 4432
BASELINE (1990)	76.482	FLT HD NAIL S CB IMPERIAL HWY 12FT W BCR @ SW COR CRENSHAW BLVD 36FT S & 85FT W C/L INT	DY 4769
CULVER (1990)	160.169	USC&GS MON FL 49FT E & 118FT S/O INT CRENSHAW BLVD & 67TH ST 12FT NW OF N RAIL AT&SFRR & 13FT E/O E CB CRENSHAW BLVD MKD (A-415 1935)	DY 5163
WATTS (1990)	159.225	USC&GS MON 13IN UP 187FT E & 39FT S/O INT OF CRENSHAW BLVD & 67TH ST & 67FT W/O INT S CB & AT&SFRR MKD (Z-414 1935)	DY 5164
BASELINE (1990)	99.659	LACE MON IN WELL @ OR NR C/L INT FIGUEROA ST & ROSECRANS AVE MKD (TRAV STA WATTS C 12 B 1946)	DY 5716
BASELINE (1990)	90.453	L&BT SPK N CB HARBOR FRWY OVERPASS 35.5FT W BCR 42FT N C/L ROSECRANS AVE 70FT E C/L FWY	DY 5717
BASELINE (1990)	89.118	L&SPK N CB ROSECRANS AVE 2FT E BCR 159FT W C/L HARBOR FREEWAY OVERPASS & 42FT N C/L ROSECRANS AVE 23FT E C/L HOOVER ST	DY 5718
BASELINE (1990)	79.018	LACS BM MON IN WELL IN PKWY @ NW COR CRENSHAW BLVD & 113TH ST 26FT N & 45FT W/O C/L INT MKD (BM 27-70A 1960 RE5869)	DY 5743
WATTS (1990)	119.128	L & T 2FT N BCR @ NE COR IMPERIAL HWY & VAN NESS AVE 30FT E & 80FT N C/L INT	DY 5745
WATTS (1990)	155.457	BT SPK E CB 1FT N BCR @ NE COR IMPERIAL HWY & FIGUEROA ST 33FT E & 60FT N C/L INT	DY 5748
WATTS (1990)	141.215	CT SPK S CB 25FT E BCR @ SE COR BROADWAY & IMPERIAL HWY 36FT S & 60FT E C/L INT	DY 5749
BASELINE (1990)	119.671	CS MON CONC FOUNDATION SW LEG TRANSMISSION LINE TOWER NO 26503 33FT E C/L E BBL ALAMEDA ST & 118 FT N C/L SOUTHERN AVE MKD (LC 769 1945)	DY 5771

QUAD-YEAR	ELEV	DESCRIPTION (INCLUDE QUAD AND YEAR IN DESCRIPTION)	BM NUMBER
BASELINE (1990)	113.584	RD MON CONC BASE FORMER RR SIGNL 68FT E C/L W BB ALAMEDA ST & 30FT N C/L TWEEDY BLVD MKD (BM 30)	DY 5773
BASELINE (1990)	102.863	CS MON IN CONC POST 2IN UP 1FT E OF E CB ALAMEDA ST W BBL & 199 N C/L CENTURY BLVD MKD (RE 2177-6) USE SE EDGE	DY 5775
BASELINE (1990)	101.964	CS MON IN CONC POST 3FT W OF W CB ALAMEDA ST & 199FT N C/L CENTURY BLVD USE S EDGE	DY 5776
BASELINE (1990)	91.299	LACE HEX MON IN WELL 32FT E C/L ALAMEDA ST W BBL & 34FT S C/L IMPERIAL HWY	DY 5779
BASELINE (1990)	91.179	L&BN IN CB 10FT S BCR @ SE COR 25FT E/O C/L ALAMEDA ST (W BARREL) & 0 FT S/O C/L IMPERIAL HWY MKD (BM)	DY 5780
WATTS (1990)	87.764	L&T S CB 1FT W BCR @ SW COR MONA AVE & IMPERIAL HWY 40 FT S & 30FT W C/L INT	DY 5781
WATTS (1990)	89.205	L&T S CB 1FT E BCR @ SE COR GORMAN AVE & IMPERIAL HWY 40FT S & 33FT E C/L INT	DY 5782
BASELINE (1990)	159.226	LACE HEX BAR MON IN WELL @ C/L INT CRENSHAW BLVD & FLORENCE AVE (26-62 CO ENGR)	DY 6804
BASELINE (1990)	158.276	WIRE SPK W CB 5FT N BCR @ NW COR CRENSHAW BLVD & FLORENCE AVE 60FT N & 38FT W C/L INT	DY 6805
BASELINE (1990)	50.024	LACS BM MON FL IN F C WALL 6FT N/O CB E SIDE CHANNEL 46FT N & 191FT E/O C/L INT ROSECRANS AVE & CRENSHAW BLVD MKD (21-11A 1964 RE 5869)	DY 6842
BASELINE (1990)	49.750	L&BN E CB 1FT N BCR @ NE COR CRENSHAW BL & ROSECRANS AVE 38FT E & 76FT N/O C/L INT	DY 6843
BASELINE (1990)	45.832	LACS BM MON IN WELL 62FT W/O C/L CRENSHAW BLVD & 6FT S C/L PROD 134TH ST MKD (BM 27-76 A 1960 RE 5869)	DY 6844
BASELINE (1990)	57.586	LAFC BR CAP MON SW COR C B ON NE COR CRENSHAW BLVD & DOMINGUEZ CHANNEL 39FT E/O C/L & 143FT N/O INT 120TH ST MKD BM (114 51 1948)	DY 6848
BASELINE (1990)	57.574	L&BN W CB 98FT N/O BCR NW COR CRENSHAW BLVD & 120TH ST 160FT N & 38FT W/O C/L INT 1FT S/O N END OF CB	DY 6849
BASELINE (1990)	90.954	LACS BM MON IN WELL ON SW COR CRENSHAW BLVD & 109TH ST (TO THE WEST) 19FT S & 70FT W C/L INT MKD (BM 27-69A 1960)	DY 6850

QUAD-YEAR	ELEV	DESCRIPTION (INCLUDE QUAD AND YEAR IN DESCRIPTION)	BM NUMBER
BASELINE (1990)	214.213	LACS BM MON IN WELL 1FT BK OF CB FACE @ SW COR CRENSHAW BLVD & MANCHESTER BLVD 104FT S & 40FT W C/L INT MKD (BM 27-66 1953)	DY 6853
BASELINE (1990)	225.028	LACE HEX BAR MON IN WELL @ C/L INT 81ST E & 8TH AVE (27-65 CO ENGR-CLA 18-10730)	DY 6855
BASELINE (1990)	242.662	LACE BM MON FL IN CONC 3FT W/O CB S-W COR CRENSHAW BLVD & 80TH ST 38FT W & 45FT S/O C/L INT MKD (24320 FT 13-C 27-64 CO ENGR CLA 18- 10770)	DY 6856
BASELINE (1990)	70.369	CS MON 8IN DN NE COR ROSECRANS AVE & OLEANDER ST 39FT N & 71FT E C/L INT MKD (BM 21-1 1952)	DY 6973
WATTS (1990)	45.888	CS MON 10IN DN 1FT N CB @ NE COR ROSECRANS AVE & WESTERN AVE 179FT E & 41FT N C/L INT MKD (BM 21-9A 1960 RE 5869)	DY 6975
BASELINE (1990)	69.837	BT SPK&L E CB 9FT S BCR @ SE COR ROSECRANS AVE & E BBL ALAMEDA ST 16FT SW OF NW COR CO HEALTH DEP BLDG 300 ROSECRANS AVE	DY 6976
BASELINE (1990)	73.460	CS MON FL IN C B ON NE COR ALAMEDA ST (E BARREL) & EUCLID AVE 45FT N & 27FT E C/L INT MKD (BM 5-19A 1964)	DY 6977
BASELINE (1990)	82.002	L&BN E CB 1FT S BCR @ SE COR ALAMEDA ST E BBL & DIXON AV 40FT S & 20FT E APPROX C/L INT MKD (BM)	DY 6978
BASELINE (1990)	82.498	RDBM TAG IN CONC APRON ON SE COR ALAMEDA ST E BB & DIXON AVE 15FT S & 50FT E APPROX C/L INT MKD (BM)	DY 6979
BASELINE (1990)	95.685	L&BN W CB 1FT N BCR @ NW COR ALAMEDA ST W BBL & SANTA ANA BLVD 30FT W & 105FT N APPROX C/L INT	DY 6980
WATTS (1990)	134.463	L&BN W CB 55FT S BCR @ SW COR EL SEGUNDO BLVD & MAIN ST 135FT S & 35FT W C/L INT	DY 7214
WATTS (1990)	60.917	FC MON IN RD WELL 8IN DN @ C/L INT NORMANDIE AVE & 135TH ST MKD (LA CO F C DIST)	DY 7216
WATTS (1990)	60.537	L&T W CB 0.6FT S BCR @ SW COR NORMANDIE AVE & 135TH ST 65FT S & 30FT W C/L INT	DY 7217
WATTS (1990)	117.157	L&BN E CB 20FT S/O BCR @ SE COR MAIN ST & 135TH ST 87FT S & 40FT E C/L INT	DY 7218
WATTS (1990)	117.663	RDBM TAG E CB 1FT S BCR @ SE COR MAIN ST & 136TH ST 42FT S & 82FT E C/L INT	DY 7219

QUAD-YEAR	ELEV	DESCRIPTION (INCLUDE QUAD AND YEAR IN DESCRIPTION)	BM NUMBER
WATTS (1990)	149.664	LACE MON 12IN DN @ C/L INT MANCHESTER AVE & BUDLONG AVE	DY 7222
WATTS (1990)	150.089	L&BN S CB 1.5FT W BCR @ SW COR BUDLONG AVE & MANCHESTER AVE 35FT S & 42FT W C/L INT	DY 7223
WATTS (1990)	158.746	L&T W CB 24FT N BCR @ NW COR BUDLONG AVE & 92ND ST 54FT N & 20FT W C/L INT	DY 7224
WATTS (1990)	214.214	L&T E CB NORMANDIE AVE 30FT E C/L & ON C/L PROD 108TH ST	DY 7229
WATTS (1990)	135.854	RDBM TAG W CB 1FT N BCR @ NW COR MAIN ST & 131ST ST 63FT N & 40FT W C/L INT	DY 7231
WATTS (1990)	133.239	RDBM TAG W CB 1FT S BCR @ SW COR MAIN ST & 131ST ST 40FT W & 62FT S C/L INT	DY 7232
WATTS (1990)	129.596	LA CITY DEPT OF PUBLIC WORKS MON FL 2FT W CB 154FT N & 35FT W C/L INT CENTRAL AVE & MANCHESTER AVE (MKD NO 11 M 130.60 ELEV)	DY 7733
WATTS (1990)	128.837	L&SPK 2FT S BCR 59FT S & 35FT E/O C/L INT CENTRAL AVE & MANCHESTER AVE	DY 7734
BASELINE (1990)	154.641	BRASS MON FL ON C/L FLORENCE AVE & 4FT E C/L E BARREL ALAMEDA ST MKD (CE MON-USE NE COR)	DY 7775
BASELINE (1990)	206.518	LACE MON IN WELL 10IN DN @ C/L INT CRENSHAW BLVD & 76TH ST	DY 7843
BASELINE (1990)	240.419	RDBM TAG 4FT E BCR 18FT N & 69FT E C/L INT CRENSHAW BLVD & 80TH ST	DY 7844
BASELINE (1990)	224.444	L&BN 2FT W BCR 18FT S & 49FT W/O C/L INT 8TH AVE & 80TH ST TO W	DY 7845
BASELINE (1990)	210.145	L&BR E CB 8TH AVE 20FT E/O C/L ON C/L PROD 84TH ST TO W	DY 7846
BASELINE (1990)	209.967	L&BR 2FT S BCR 47FT S & 20FT W/O C/L INT 8TH AVE & 84TH ST TO W	DY 7847
BASELINE (1990)	213.629	L&T 4FT N/O BCR 83FT N & 38FT E/O C/L INT CRENSHAW BLVD & 90TH ST TO THE E	DY 7848
BASELINE (1990)	206.305	L&PK 4FT N BCR 33FT N & 38FT E/O C/L INT CRENSHAW BLVD & ARBOR VITAE ST TO E	DY 7850
BASELINE (1990)	194.091	L&DN NE COR C B 44FT S & 42FT E/O C/L INT CRENSHAW BLVD & HARDY ST	DY 7852

QUAD-YEAR	ELEV	DESCRIPTION (INCLUDE QUAD AND YEAR IN DESCRIPTION)	BM NUMBER
BASELINE (1990)	127.447	L&DN IN NE COR C B 75FT N & 42FT E/O C/L INT CRENSHAW BLVD & 104TH ST	DY 7853
BASELINE (1990)	124.688	L&BR 8FT S/O BCR OF ISLE 34FT S & 41FT E/O C/L INT CRENSHAW BLVD & 104TH ST	DY 7854
BASELINE (1990)	91.910	SPK&L E CB 10FT S & 38FT E/O C/L CRENSHAW BLVD & 109TH ST (TO THE W)	DY 7855
BASELINE (1990)	70.800	L&BR E CB 40FT E C/L CRENSHAW BLVD @ C/L PROD 116TH ST TO W	DY 7857
BASELINE (1990)	70.087	L&SPK IN W CB 38FT W 65FT S/O C/L INT CRENSHAW BLVD & 116TH ST TO W (MKD KE-6)	DY 7858
BASELINE (1990)	53.971	RDBM TAG IN CONC BASE TRAFFIC LIGHT 53FT S & 43FT W/O C/L INT CRENSHAW BLVD & NORTHROP AVE	DY 7859
BASELINE (1990)	49.444	L AFC BR CAP MON FL IN N ABUT TO BRIDGE OVER F C CHANNEL 50FT E/O C/L CRENSHAW BLVD & 191FT N/O 132ND ST MKD (BM 114-63 1959)	DY 7860
BASELINE (1990)	46.524	L&BN IN N WALL L AFC CHANNEL 49FT W/O C/L CRENSHAW BLVD & 187FT N C/L 132ND ST	DY 7861
BASELINE (1990)	46.314	RDBM TAG IN W CB 8FT N & 40FT W C/L INT CRENSHAW BLVD & 134TH ST	DY 7862
BASELINE (1990)	47.213	CS BR CAP MON NE COR C B 19FT N & 65FT W C/L INT CRENSHAW BLVD & 139TH ST MKD (BM 27-77A 1965 5869)	DY 7863
BASELINE (1990)	47.163	L&SPK IN N END C B 1FT W/O CB 36FT S & 41FT W/O C/L INT 139TH ST & CRENSHAW BLVD	DY 7864
BASELINE (1990)	72.164	L&BN SCB 38FT S & 35FT E C/L INT ROSECRANS AVE & ARANBE AVE 5FT E/O BCR	DY 7866
BASELINE (1990)	85.374	L&T 9FT W/O BCR 40FT S & 68FT W/O C/L INT ROSECRANS AVE & TAJAUTA AVE	DY 7867
BASELINE (1990)	96.617	RDBM TAG IN CONC CB PLANTER 52FT S & 6FT E C/L INT ROSECRANS AVE & PARMLEE AVE	DY 7869
BASELINE (1990)	113.954	RDBM TAG 5FT N BCR 65FT S & 41FT E C/L INT ROSECRANS AVE & AVALON BLVD	DY 7870
BASELINE (1990)	112.798	RDBM TAG 4FT W BCR 40FT S & 80FT W C/L INT ROSECRANS AVE & AVALON BLVD	DY 7871
BASELINE (1990)	105.483	RDBM TAG 4FT S BCR 86FT S & 32FT E C/L INT ROSECRANS AVE & SAN PEDRO ST	DY 7872

QUAD-YEAR	ELEV	DESCRIPTION (INCLUDE QUAD AND YEAR IN DESCRIPTION)	BM NUMBER
BASELINE (1990)	106.732	RDBM TAG 4FT W/O BCR 40FT S & 64FT W C/L INT ROSECRANS AVE & SAN PEDRO ST	DY 7873
BASELINE (1990)	112.423	RDBM TAG 3FT E BCR 40FT N & 76FT E C/L INT ROSECRANS AVE & MAIN ST	DY 7874
BASELINE (1990)	112.180	LACS MON IN WELL 8IN DN 2FT W CB 74FT S & 42FT W C/L INT ROSECRANS AVE & MAIN ST (MKD BM 21-5A 1970)	DY 7875
BASELINE (1990)	114.692	L & T @ MCR 52FT S & 46FT E C/L INT ROSECRANS AVE & BROADWAY	DY 7876
BASELINE (1990)	113.947	RDBM TAG 4FT S BCR 80FT S & 40FT W C/L INT ROSECRANS AVE & BROADWAY	DY 7877
BASELINE (1990)	100.680	RDBM TAG 2FT S BCR 65FT S & 40FT E C/L INT ROSECRANS AVE & FIGUEROA ST	DY 7878
BASELINE (1990)	60.202	RDBM TAG 3FT W BCR 42FT S & 48FT W C/L INT ROSECRANS AVE & VERMONT AVE (W BBL)	DY 7879
BASELINE (1990)	52.014	RDBM TAG 1FT E BCR 40FT S & 45FT E C/L INT ROSECRANS AVE & BUDLONG AVE	DY 7880
BASELINE (1990)	51.392	RDBM TAG 1FT S BCR 66FT S & 18FT W C/L INT ROSECRANS AVE & BUDLONG AVE	DY 7881
BASELINE (1990)	47.233	RDBM TAG 40FT S/O BCR 108FT S & 30FT E/O C/L INT ROSECRANS AVE & NORMANDIE AVE	DY 7882
BASELINE (1990)	46.986	RDBM TAG 3FT E BCR 40FT S & 62FT W C/L INT ROSECRANS AVE & NORMANDIE AVE	DY 7883
BASELINE (1990)	45.938	RDBM TAG 23FT E BCR 40FT S & 66FT E C/L INT ROSECRANS AVE & HALLDALE AVE	DY 7884
BASELINE (1990)	45.729	RDBM TAG IN W CB @ N END C B 5FT S BCR 71FT S & 18FT W C/L INT ROSECRANS AVE & HALLDALE AVE	DY 7885
BASELINE (1990)	45.185	RDBM TAG 1FT N BCR 64FT S & 18FT E C/L INT ROSECRANS AVE & DENKER AVE	DY 7886
BASELINE (1990)	45.702	RDBM TAG 5FT W BCR 40FT S & 49FT W C/L INT ROSECRANS AVE & DENKER AVE	DY 7887
BASELINE (1990)	46.747	L&BN 4FT S BCR 35FT W C/L WESTERN AVE & 67FT S C/L ROSECRANS AVE (MKD BM)	DY 7888
BASELINE (1990)	102.638	RDBM TAG 3FT N BCR 94FT S & 38FT E C/L INT CENTRAL AVE & ROSECRANS AVE	DY 7889

QUAD-YEAR	ELEV	DESCRIPTION (INCLUDE QUAD AND YEAR IN DESCRIPTION)	BM NUMBER
WATTS (1990)	98.504	L&ENG TAG 1FT N BCR 47FT N & 38FT E/O C/L INT CENTRAL AVE & PIRU ST	DY 7890
WATTS (1990)	97.479	L&BN 2FT N BCR 56FT N & 80FT W/O C/L INT CENTRAL AVE (SER RD) & 135TH ST	DY 7891
WATTS (1990)	94.299	L&T 15FT S BCR 72FT S & 38FT E/O C/L INT CENTRAL AVE & 131ST ST (MKD S D 523)	DY 7892
WATTS (1990)	93.694	RDBM TAG 5FT S BCR OF ISL @ N END C B 44FT S & 38FT W C/L INT CENTRAL AVE & 131ST ST TO W	DY 7893
WATTS (1990)	92.789	RDBM TAG 5FT S BCR 48FT S & 40FT W C/L INT CENTRAL AVE & 118TH ST	DY 7894
WATTS (1990)	92.811	RDBM TAG 5FT E BCR 15FT N & 65FT E C/L INT CENTRAL AVE & 118TH ST	DY 7895
WATTS (1990)	153.392	L&T NR MCR 25FT N & 24FT W/O C/L INT BUDLONG AVE & 89TH ST	DY 7924
WATTS (1990)	158.785	L&T NR MCR 15FT S & 25FT W/O C/L INT BUDLONG AVE & 92ND ST	DY 7926
WATTS (1990)	160.123	RDBM TAG 3FT E BCR 20FT S & 43FT E C/L INT BUDLONG AVE & 95TH ST	DY 7928
WATTS (1990)	167.080	L&BN 30FT S BCR 80FT S & 20FT W/O C/L INT CENTURY BLVD & BUDLONG AVE	DY 7930
WATTS (1990)	189.658	RDBM TAG 2FT W BCR 30FT N & 48FT E C/L INT CENTURY BLVD & NORMANDIE AVE	DY 7931
WATTS (1990)	197.025	RDBM TAG 2FT E BCR 15FT S & 52FT E C/L INT NORMANDIE AVE & 104TH ST	DY 7933
WATTS (1990)	213.558	RDBM TAG 1FT W BCR 15FT N & 55FT W C/L INT NORMANDIE AVE & 110TH PL	DY 7936
WATTS (1990)	212.741	L&T E CB 30FT E C/L NORMANDIE AVE ON C/L PROD 110TH PL	DY 7937
WATTS (1990)	201.124	RDBM TAG 1FT S BCR 60FT S & 30FT W C/L INT NORMANDIE AVE & IMPERIAL HWY	DY 7938
WATTS (1990)	170.044	L&BN W CB 4FT N & SP RR 30FT W/O C/L INT NORMANDIE AVE & SP RR (0.3MI S/O IMPERIAL HWY)	DY 7939
WATTS (1990)	170.691	L&T 0.5FT S BCR OF DRWY 40FT S & 30FT E/O C/L INT NORMANDIE AVE & SP RR (0.3MI S/O C/L IMPERIAL HWY)	DY 7940

QUAD-YEAR	ELEV	DESCRIPTION (INCLUDE QUAD AND YEAR IN DESCRIPTION)	BM NUMBER
WATTS (1990)	192.288	RDBM TAG 10FT W BCR 32FT N & 77FT W C/L INT NORMANDIE AVE & 120TH ST	DY 7941
WATTS (1990)	151.954	L&T 1FT W BCR 20FT N & 56FT W/O C/L INT NORMANDIE AVE & 125TH ST	DY 7942
WATTS (1990)	153.473	RDBM TAG 2FT W BCR 20FT S & 53FT E C/L INT NORMANDIE AVE & 125TH ST	DY 7943
WATTS (1990)	87.186	RDBM TAG 4FT N BCR @ S END C B 58FT N & 30FT E C/L INT NORMANDIE AVE & 132ND ST	DY 7944
WATTS (1990)	85.303	RDBM TAG 2FT E BCR 30FT S & 57FT E C/L INT NORMANDIE AVE & 132ND ST	DY 7945
WATTS (1990)	50.171	RDBM TAG IN E CB @ S EDGE C B 47FT N & 30FT E C/L INT NORMANDIE AVE & 139TH ST	DY 7946
WATTS (1990)	50.248	SPK&L 12FT S BCR 54FT S & 30FT W/O C/L INT NORMANDIE AVE & 139TH ST	DY 7947
WATTS (1990)	146.362	RDBM TAG 4FT N BCR 72FT N & 40FT E C/L INT EL SEGUNDO BLVD & BROADWAY	DY 7960
WATTS (1990)	105.235	L&BR 8FT W BCR OF ISLAND 40FT S & 45FT W/O C/L INT IMPERIAL HWY & CASIMIR AVE	DY 7969
WATTS (1990)	105.630	L&BR 5FT E BCR OF ISLAND 40FT S & 41FT E/O C/L INT IMPERIAL HWY & CASIMIR AVE	DY 7970
WATTS (1990)	116.592	RDBM TAG IN S CB SERVICE RD 2FT W BCR 80FT S & 124FT W C/L INT IMPERIAL HWY & VAN NESS AVE	DY 7971
WATTS (1990)	151.652	RDBM TAG IN S CB SERVICE RD 4FT W BCR 80FT S & 40FT W C/L INT IMPERIAL HWY & WILTON PL	DY 7972
WATTS (1990)	155.613	RDBM TAG 3FT E BCR 38FT S & 58FT E C/L INT IMPERIAL HWY & WILTON PL	DY 7973
WATTS (1990)	201.399	RDBM TAG 3FT S ECR 73FT S & 42FT W C/L INT IMPERIAL HWY & WESTERN AVE	DY 7974
WATTS (1990)	203.051	L&BN 30FT E BCR 40FT S & 110FT E/O C/L INT IMPERIAL HWY & WESTERN AVE MKD (BM)	DY 7975
WATTS (1990)	210.038	RDBM TAG 5FT W BCR 40FT N & 50FT W C/L INT IMPERIAL HWY & DENKER AVE	DY 7976
WATTS (1990)	173.978	FLT HD SPK 3FT N BCR 55FT N & 28FT E C/L INT IMPERIAL HWY & HOOVER ST	DY 7980

QUAD-YEAR	ELEV	DESCRIPTION (INCLUDE QUAD AND YEAR IN DESCRIPTION)	BM NUMBER
WATTS (1990)	174.554	L&T 2.5FT E BCR 34FT S & 43;T E/O C/L INT IMPERIAL HWY & HOOVER ST	DY 7981
WATTS (1990)	141.081	BT SPK 12FT E BCR @ W END C B 30FT N & 48FT E C/L INT IMPERIAL HWY & BROADWAY	DY 7982
WATTS (1990)	128.435	FLT HD SPK 30FT S BCR 82FT S & 25FT W C/L INT IMPERIAL HWY & MAIN ST	DY 7983
WATTS (1990)	127.102	RDBM TAG 4FT E BCR OF ISLE 40FT S & 75FT E C/L INT IMPERIAL HWY & MAIN ST	DY 7984
WATTS (1990)	123.819	RDBM TAG 1FT S BCR 32FT W C/L SAN PEDRO ST & 10FT S C/L IMPERIAL HWY PROD	DY 7985
WATTS (1990)	122.846	RDBM TAG 16FT E BCR 40FT S & 66FT E C/L INT IMPERIAL HWY & SAN PEDRO ST	DY 7986
WATTS (1990)	102.337	SPK&L IN C B 6FT W BCR 55FT N & 56FT W/O C/L INT IMPERIAL HWY & WADSWORTH AVE	DY 7987
WATTS (1990)	101.593	RDBM TAG 4FT E BCR 44FT S & 79FT E C/L INT IMPERIAL HWY & WADSWORTH AVE	DY 7988
WATTS (1990)	94.096	ST DIV HWYS STAN STEEL PLATE & W 20FT N ECR 82FT N & 19FT W C/L INT IMPERIAL HWY & COMPTON AVE N	DY 7989
WATTS (1990)	93.114	FLT HD SPK 9FT N ECR IN N END C B 69FT N & 10FT W C/L INT IMPERIAL HWY & GRANDEE AVE	DY 7990
WATTS (1990)	91.845	L&BN 41FT W BCR 40FT S & 112FT W/O C/L INT IMPERIAL HWY & WILMINGTON AVE	DY 7991
WATTS (1990)	92.246	RDBM TAG 6FT S ECR 74FT S & 40FT E C/L INT IMPERIAL HWY & WILMINGTON AVE	DY 7992
WATTS (1990)	89.447	FLT HD SPK 10FT W BCR IN W END C B 40FT S & 38FT W/O C/L INT IMPERIAL HWY & LOU DILLON AVE	DY 7993
WATTS (1990)	90.174	L&T IN N CB 40FT N & 34FT W/O C/L IMPERIAL HWY & LOU DILLON AVE	DY 7994
WATTS (1990)	113.639	L&BN 9FT S BCR 64FT S & 40FT E/O C/L INT MAIN ST & 140TH ST	DY 8006
WATTS (1990)	152.304	L&N @ MCR 23FT S & 28FT E/O C/L INT BROADWAY & 117TH ST	DY 8009
WATTS (1990)	129.171	L&CE TAG N CB 37FT N/O C/L FIRESTONE BLVD ON C/L PROD OF ZAMORA AVE TO THE SOUTH	DY 8013

QUAD-YEAR	ELEV	DESCRIPTION (INCLUDE QUAD AND YEAR IN DESCRIPTION)	BM NUMBER
WATTS (1990)	128.938	L&T 1FT E BCR 35FT N & 56FT E/O C/L INT CENTRAL AVE & MANCHESTER AVE	DY 8015
WATTS (1990)	129.392	L&T 1FT N BCR 50FT N & 15FT W/O C/L INT MCKINLEY AVE & MANCHESTER AVE	DY 8017
WATTS (1990)	129.623	SPK&L 13FT W/O BCR 35FT S & 46FT W/O C/L INT MCKINLEY PL & MANCHESTER AVE	DY 8018
WATTS (1990)	131.944	SPK&L 20FT N BCR 70FT N & 33FT W/O C/L INT MANCHESTER AVE & AVALON BLVD	DY 8019
WATTS (1990)	131.689	SPK&L 1FT W BCR 35FT S & 53FT W/O C/L INT MANCHESTER AVE & AVALON BLVD	DY 8020
WATTS (1990)	130.599	SPK&L 10FT E BCR 35FT N & 64FT E/O C/L INT MANCHESTER AVE & SAN PEDRO ST	DY 8021
WATTS (1990)	131.685	CUT SPK IN NE COR C B 68FT N 31FT E C/L INT MANCHESTER AVE & MAIN ST	DY 8023
WATTS (1990)	130.954	L&T 14FT W BCR 35FT S & 56FT W/O C/L INT MANCHESTER AVE & MAIN ST	DY 8024
WATTS (1990)	130.606	CUT SPK IN NW COR C B 39FT N & 68FT E C/L INT MANCHESTER AVE & BROADWAY	DY 8025
WATTS (1990)	130.452	CUT SPK IN NW COR C B 39FT N & 62FT E C/L INT MANCHESTER AVE & FIGUEROA ST	DY 8027
WATTS (1990)	130.193	L&T 1FT S BCR 61FT S & 32FT W/O C/L INT MANCHESTER AVE & FIGUEROA ST	DY 8028
WATTS (1990)	132.910	SQ SPK & L 15FT S ECR 70FT S & 24FT E C/L INT MANCHESTER AVE & HOOVER ST TO N	DY 8029
WATTS (1990)	133.448	L&T 40FT W BCR 35FT S & 75FT W/O C/L INT MANCHESTER AVE & HOOVER ST TO S	DY 8030
WATTS (1990)	137.908	RDBM TAG IN E CB 51FT S & 35FT E/O C/L INT E BBL MANCHESTER AVE & VERMONT AVE	DY 8031
WATTS (1990)	139.759	SPK&L W CB 70FT S & 52FT W/O C/L INT W BBL MANCHESTER AVE & VERMONT AVE	DY 8032
WATTS (1990)	162.968	SPK&L 15FT S BCR 71FT S & 27FT E/O C/L INT MANCHESTER AVE & NORMANDIE AVE	DY 8033
WATTS (1990)	163.579	RDBM TAG 1FT E BCR 35FT S & 55FT W C/L INT MANCHESTER AVE & NORMANDIE AVE	DY 8034

QUAD-YEAR	ELEV	DESCRIPTION (INCLUDE QUAD AND YEAR IN DESCRIPTION)	BM NUMBER
WATTS (1990)	174.477	RDBM TAG IN NE COR C B 64FT S & 24FT E C/L INT MANCHESTER AVE & DENKER AVE	DY 8035
WATTS (1990)	187.527	RDBM TAG 2FT E BCR 35FT S & 58FT E C/L INT MANCHESTER AVE & WESTERN AVE	DY 8037
WATTS (1990)	188.763	RDBM TAG 2.5FT W BCR 35FT N & 58FT W C/L INT MANCHESTER AVE & WESTERN AVE	DY 8038
WATTS (1990)	203.849	FLT HD SPK 10FT N ECR 58FT N & 18FT E C/L INT MANCHESTER AVE & GRAMERCY PL	DY 8039
WATTS (1990)	219.453	SPK&L 4FT N BCR 68FT N & 18FT E/O C/L INT MANCHESTER AVE & FIFTH AVE	DY 8042
WATTS (1990)	219.501	RDBM TAG 3FT W BCR 38FT S & 33FT W C/L INT MANCHESTER AVE & FIFTH AVE	DY 8043
BASELINE (1990)	110.939	L&T S CB ROSECRANS AVE (N CB ISLAND) 42.5FT S & 52FT W C/L INT ROSECRANS AVE & CAHITA AVE	DY 8191
BASELINE (1990)	127.652	L&T 28FT E/O C/L ALAMEDA ST ON C/L PROD 85TH ST	DY 8797
BASELINE (1990)	51.015	LACS BM MON IN SLY WALL LAGUNA DOMINGUEZ CHANNEL 1FT SW OF SW COR BRIDGE NO 1276 SW COR ROSECRANS AVE & CRENSHAW BLVD 241FT S & 43FT W/O C/L INT MKD (21- 12A 1964 RE 5869)	DY 9269
BASELINE (1990)	170.538	L&PK IN CB RET NE COR CRENSHAW BLVD & CENTURY BLVD 66FT E & 38FT N/O C/L INT 2FT W/O BCR	DY 9271
BASELINE (1990)	207.963	RDBM TAG S CB 1FT E/O BCR S-E COR CRENSHAW BLVD & 76TH ST TO THE E 51FT E & 18FT S/O C/L INT	DY 9272
BASELINE (1990)	71.319	RDBM TAG IN CB 5FT E BCR INTO RET @ SW COR ROSECRANS AVE & ALAMEDA ST (E BARREL) 33FT S & 33FT W/O C/L INT	DY 9313
BASELINE (1990)	78.036	RAMSET 2FT S BCR @ SE COR ALAMEDA ST E BBL 24FT E/O & 52FT S/O C/L INT BANNING ST	DY 9314
BASELINE (1990)	87.507	RAMSET IN CTR CB RET @ SE COR ALAMEDA ST E BBL & LYNWOOD RD 20FT E & 32FT S/O C/L INT	DY 9315
BASELINE (1990)	112.835	RDBM TAG IN CB 4FT S/O BCR @ SE COR (E BARREL) ALAMEDA ST & KANSAS AVE 18FT E & 37FT S/O C/L INT	DY 9317
BASELINE (1990)	117.991	RDBM TAG 4FT S BCR @ SE COR E BBL ALAMEDA ST IN NLY WALL C B 19FT E & 45FT S C/L INT SOUTHERN AV	DY 9318

QUAD-YEAR	ELEV	DESCRIPTION (INCLUDE QUAD AND YEAR IN DESCRIPTION)	BM NUMBER
BASELINE (1990)	138.803	CS MON IN WELL 30FT E & 15FT S/O APPROX C/L INT W BBL ALAMEDA ST & NADEAU ST USE W EDGE	DY 9321
BASELINE (1990)	149.270	L&T 28FT E C/L ALAMEDA ST NEAR C/L PROD 76TH ST	DY 9322
BASELINE (1990)	161.109	L&T 20FT W C/L E BBL ALAMEDA ST ON OR NEAR C/L PROD ZOE AVE	DY 9323
WATTS (1990)	62.547	RDBM TAG 1FT E/O BCR @ NE COR ROSECRANS AVE & E BBL VERMONT AVE 42FT N & 50FT E/O C/L INT	DY 9326
WATTS (1990)	153.514	L&T @ CTR CB RET @ SW COR BUDLONG AVE & 89TH ST 26FT W & 24FT S/O C/L INT	DY 9625
WATTS (1990)	166.248	L&T 5FT W/O BCR @ SE COR CENTURY BLVD & BUDLONG AVE 39FT S & 37FT E/O C/L INT BUDLONG AVE TO SO	DY 9626
WATTS (1990)	214.433	RDBM TAG 2FT S/O BCR @ SW COR NORMANDIE AVE & 108TH ST 30FT W & 55FT S/O C/L INT	DY 9627
WATTS (1990)	119.288	RDBM TAG 6FT S/O BCR @ SW COR NORMANDIE AVE & EL SEGUNDO BLVD 30FT W & 70FT S/O C/L INT	DY 9628
WATTS (1990)	97.713	RAMSET CTR CB RET @ NE COR IMPERIAL HWY & CENTRAL AVE 53FT N & 44FT E/O C/L INT	DY 9632
WATTS (1990)	198.214	L&LACE TAG 5FT S/O BCR OF ISLAND 36FT E & 51FT S/O C/L INT VERMONT AVE (W BBL) & IMPERIAL HWY	DY 9633
WATTS (1990)	187.805	L&LACE TAG 38FT N/O C/L IMPERIAL HWY ON C/L PROD BUDLONG AVE TO THE S	DY 9634
WATTS (1990)	207.569	RDBM TAG 2FT E/O BCR @ NE COR IMPERIAL HWY & DENKER AVE 38FT N & 47FT E/O C/L INT	DY 9635
WATTS (1990)	213.284	L&PK 42FT E/O BCR @ SE COR MANCHESTER AVE & VAN NESS AVE 82FT E & 35FT S/O C/L INT	DY 9636
WATTS (1990)	120.278	RDBM TAG 3FT W/O BCR @ SW COR 92ND ST & HOLMES AVE 38FT W & 32FT S/O C/L INT	DY 9641
WATTS (1990)	120.343	RDBM TAG 3FT W/O BCR @ NW COR 92ND ST & HOLMES AVE 32FT N & 48FT W/O C/L INT	DY 9642
WATTS (1990)	115.661	RDBM TAG 3FT W/O BCR @ SW COR 92ND ST & HICKORY ST 50FT W & 32FT S/O C/L INT	DY 9643
WATTS (1990)	115.402	RDBM TAG 3FT E/O BCR @ SE COR 92ND ST & HICKORY ST 48FT E & 32FT S/O C/L INT	DY 9644

QUAD-YEAR	ELEV	DESCRIPTION (INCLUDE QUAD AND YEAR IN DESCRIPTION)	BM NUMBER
BASELINE (1990)	215.051	RDBM TAG E CB 2IN N BCR 38FT E/O C/L CRENSHAW BLVD & 76FT N/O C/L MANCHESTER BLVD	DY 10108
WATTS (1990)	174.617	SPK 3FT W BCR 35FT S & 42FT W/O C/L INT MANCHESTER AVE & DENKER AVE	DY 10109
WATTS (1990)	121.731	RDBM TAG IN E CB 1FT N BCR 32FT E/O C/L COMPTON AVE & 58FT N/O C/L 92ND ST	DY 10110
WATTS (1990)	121.144	RDBM TAG IN S CB 3FT E BCR 32FT S/O C/L 92ND ST & 50FT E/O C/L COMPTON AVE	DY 10111
WATTS (1990)	97.526	L&SPK 5FT S BCR 71FT S & 40FT E/O C/L INT CENTRAL AVE & IMPERIAL HWY	DY 10112
WATTS (1990)	158.121	RDBM TAG IN N END L BCR SW COR BROADWAY & 120TH ST (INT TO SO) 52FT S & 55FT E/O C/L INT	DY 10113
WATTS (1990)	158.354	RDBM TAG IN N CB 7FT W BCR @ NW COR BROADWAY & 120TH ST (INT TO NO) 28FT N & 45FT W/O C/L INT	DY 10114
BASELINE (1990)	113.587	RDBM TAG IN CB @ NE COR ALAMEDA ST (W BARREL) & TWEEDY BLVD 58FT N & 29FT E/O C/L INT (2FT N/O BCR)	DY 10141
BASELINE (1990)	124.516	L&T IN CB @ SE COR ALAMEDA ST & FIRESTONE BLVD 29FT E & 60FT S/O C/L INT (5FT N/O BCR) STAMPED (BM)	DY 10142
BASELINE (1990)	139.586	RDBM TAG IN CB @ SW COR ALAMEDA ST & NADEAU ST 35FT W & 60FT S/O APPROX C/L INT (W BARREL) 2FT S/O BCR	DY 10143
BASELINE (1990)	165.975	L&T IN CB # SE COR ALAMEDA ST (W BARREL) & GAGE AVE 40FT S & 25FT E/O C/L INT (6FT N/O BCR) STAMPED (BM)	DY 10144
BASELINE (1990)	175.271	RDBM TAG IN CB @ SE COR ALAMEDA ST (E BARREL) & RANDOLPH ST (S BARREL) 50FT S & 20FT E/O APPROX C/L INT (6FT S/O BCR)	DY 10145
BASELINE (1990)	179.372	RDBM TAG IN CB @ SW COR ALAMEDA ST (W BARREL) & SLAUSON AVE 27FT W & 55FT S/O C/L INT (3FT S/O BCR)	DY 10146
WATTS (1990)	128.754	L&CE TAG IN CB C/L PROD ZAMORA AVE FROM NORTH 37FT S/O C/L FIRESTONE BLVD & 5FT E/O BCR @ SE COR PLEVKA AVE	DY 10148
WATTS (1990)	131.081	L&SPK IN SW COR C B 70FT N & 30FT W/O C/L INT MANCHESTER AVE & SAN PEDRO ST (10FT N/O ECR @ NW COR)	DY 10149

QUAD-YEAR	ELEV	DESCRIPTION (INCLUDE QUAD AND YEAR IN DESCRIPTION)	BM NUMBER
WATTS (1990)	130.478	RD BM TAG IN CONC CB @ NW COR MANCHESTER AVE & BROADYWAY 35FT N & 64FT W/O C/L INT (1FT W/O BCR)	DY 10150
WATTS (1990)	213.302	L&SPK NE COR MANCHESTER AVE & VAN NESS AVE 55FT N & 30FT E/O C/L INT (5FT N/O BCR)	DY 10151
BASELINE (1990)	69.599	L&SPK N CB ROSECRANS AVE 38FT N & 60FT E/O C/L INT ROSECRANS AVE & WILLOWBROOK AVE (E BARREL) (7FT E/O BCR)	DY 10159
BASELINE (1990)	71.272	RDBM TAG IN N CB ROSECRANS AVE 38FT N & 35FT W/O C/L INT ROSECRANS AVE & OLEANDER AVE (2FT W/O BCR)	DY 10160
BASELINE (1990)	72.412	RDBM TAG @ NW COR C B 42FT N & 35FT W/O C/L INT ROSECRANS AVE & ARANBE AVE (6FT W/O BCR)	DY 10161
BASELINE (1990)	95.977	RDBM TAG @ NW COR C B 44FT N & 60FT W/O C/L INT ROSECRANS AVE & PARMELEE AVE (9FT W/O BCR)	DY 10162
BASELINE (1990)	113.433	RDBM TAG IN S CB ROSECRANS AVE 40FT S & 71FT E/O C/L INT ROSECRANS AVE & STANFORD AVE (17FT E/O BCR)	DY 10163
BASELINE (1990)	49.054	RDBM TAG IN CB @ NW COR CRENSHAW BLVD & EL SEGUNDO BLVD 70FT N & 42FT W/O C/L INT (1FT S/O BCR)	DY 10185
BASELINE (1990)	52.752	RDBM TAG IN CB @ NW COR CRENSHAW BLVD & NORTHROP AVE 63FT N & 42FT W/O C/L INT (1FT S/O BCR)	DY 10186
BASELINE (1990)	78.439	L&BRAD IN CB @ NE COR CRENSHAW BLVD & IMPERIAL HWY 56FT N & 44FT E/O C/L INT (18FT S/O BCR)	DY 10187
BASELINE (1990)	194.666	RDBM TAG IN CB @ NE COR CRENSHAW BLVD & HARDY ST 40 FT N & 42FT E/O C/L INT (1FT N/O BCR)	DY 10188
BASELINE (1990)	206.028	RDBM TAG IN CB @ SE COR CRENSHAW BLVD & ARBOR VITAE ST 32FT S & 42FT E/O C/L INT (1FT S/O BCR)	DY 10189
BASELINE (1990)	214.146	CITY OF INGLEWOOD TAG IN CB RET @ SW COR CRENSHAW BLVD & 90TH ST (TO THE WEST) 35FT S & 81FT W/O C/L INT (17FT E/O BCR)	DY 10190